

BLACK DIAMOND QUILT DIAGRAM

FINISHED SIZE: 54" X 63"

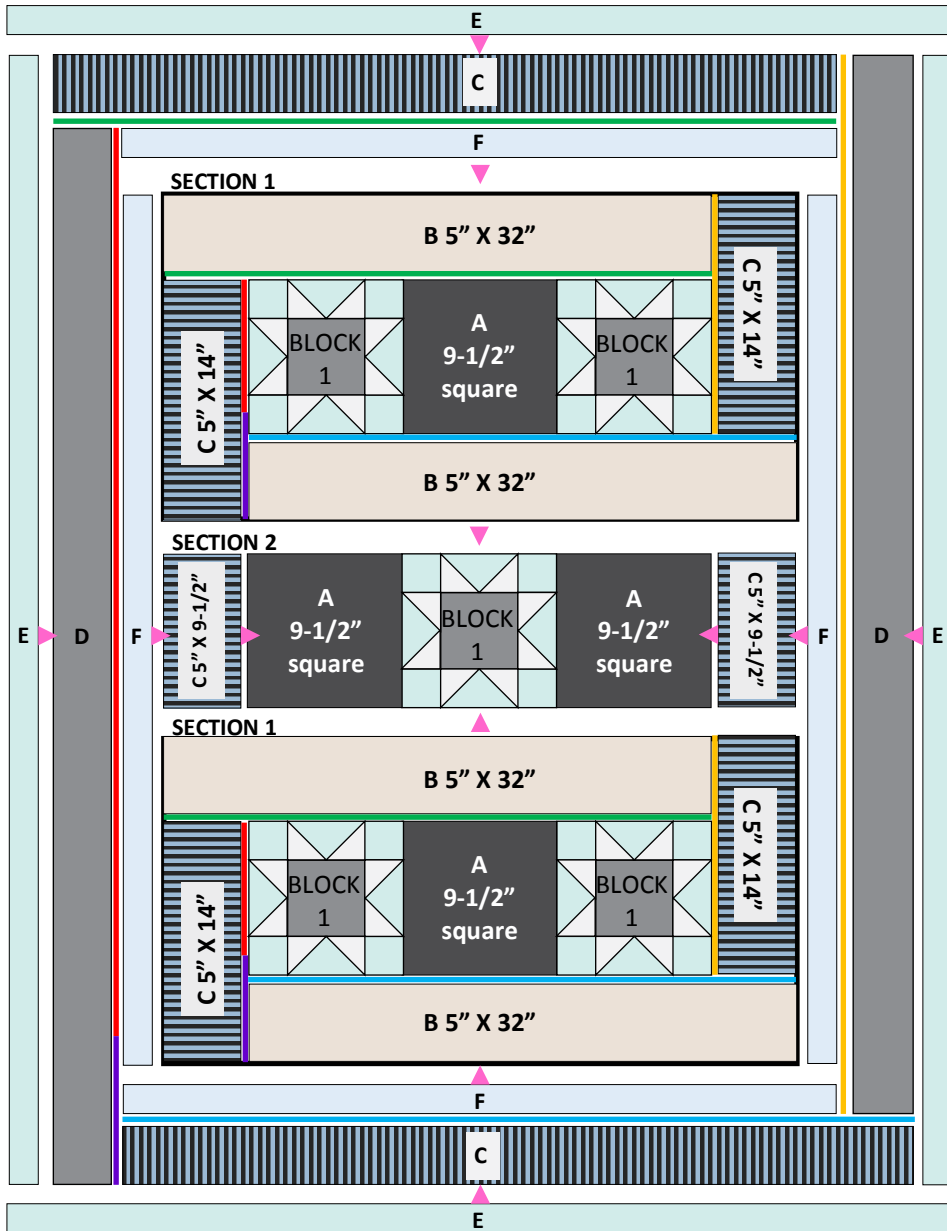

Note: If this Benartex pattern is included in a kit, any questions about the kit should be addressed to the vendor from whom you bought it.

BENARTEX, LLC • 132 WEST 36TH STREET, 4TH FLOOR • NEW YORK, NY 10018 •
T:212-840-3250 • WWW.BENARTEX.COM

BLACK DIAMOND

Designed by Stephanie Sheridan and
Linda Leathersich of Stitched Together Studios









If you're a skier, then you know all about Black Diamonds, but I assure you this "Black Diamond" is not quite as difficult. An easy pattern for quilters of all levels and using our detailed ski and ice-blue snow prints, this quilt is a great gift for the Holidays.

Uses Benartex's
Ski Country collection
by Bristol Bay Studios
Finished Size: 54" x 63"

Benartex
Fabric for quilters. By quilters.

THE QUILT SHOWN IS A DIGITAL REPRESENTATION. ACTUAL FABRIC REPEATS WILL VARY FROM DESIGN SHOWN.

BLOCK 1 ASSEMBLY DIAGRAMS

SAMPLE	KEY/SKU	QTY	CUT
 A	6023-12 @ Ski Lodge Black	1/3 YD	(1) 9-1/2" X WOF strip, subcut (4) 9-1/2" squares
 B	6025-09 @ Skis Cream	2/3 YD	(4) 5" X WOF strips, subcut (4) 5" X 32" strips
 C	6026-55 @ Nordic Beauty Teal/Black	3/4 YD	(2) 5" X WOF strips, subcut (4) 5" X 14" rectangles (2) 5" X 9-1/2" rectangles (3) 5" X WOF strips*, BORDER 2
 D	6028-12 Ski Patches Black	2/3 YD	(1) 5" X WOF strip, subcut (5) 5" squares (3) 5" X WOF strips*, BORDER 2
 E	6029-04 Snow Turquoise	1 1/3 YD	(5) 2-3/4" X WOF strips, subcut (20) 2-3/4" X 5" rectangles (20) 2-3/4" squares (6) 2-3/4" X WOF strips*, BORDER 3 (7) 2-1/4" X WOF strips, BINDING
 F	6029-05 Snow Teal	1/2 YD	(5) 2-3/4" X WOF strips*, BORDER 1
 G	6029-09 Snow Cream	1/3 YD	(3) 2-3/4" X WOF strips, subcut (40) 2-3/4" squares

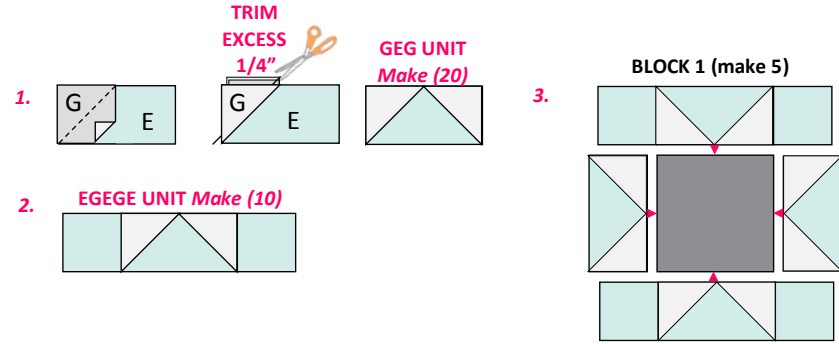

QUILT ASSEMBLY: Refer to QUILT DIAGRAM.

4. SECTION 1: Sew (1) **BLOCK 1** to each side of (1) **A** 9-1/2" square. Sew (1) **C** 5" X 14" rectangle to the left side, stopping 3" from end of **BLOCK 1** (partial seam). Sew (1) **B** 5" X 32" strip to top, then sew (1) **C** 5" X 14" rectangle to right side. Sew (1) **B** 5" X 32" strip to bottom, then complete partial seam to complete **SECTION 1**. make (2).

5. SECTION 2: Sew (1) **A** 9-1/2" square to each side of (1) **BLOCK 1**, then sew (1) **C** 5" X 9-1/2" rectangle to each end to complete **SECTION 2**, make (1).

6. Sew (1) **SECTION 1** to the top of **SECTION 2**, then sew (1) **SECTION 1** to the bottom.

BORDER ASSEMBLY: Measure width and length of quilt top to ensure border cutting sizes. Below are (our measurements).

7. Sew (1) **F** 2-3/4" X (45-1/2") strip to each side of quilt, then sew (1) **F** 2-3/4" X (41") strip to top and bottom.

8. Sew (1) **D** 5" X (54-1/2") strip to the left side, stopping 3" from end (partial seam). Sew (1) **C** 5" X (45-1/2") strip to top, then sew **D** 5" X (54-1/2") strip to right side. Sew (1) **C** 5" X (45-1/2") strip to bottom, then complete partial seam.

9. Sew (1) **E** 2-3/4" X (59") strip to each side of quilt, then sew (1) **E** 2-3/4" X (54-1/2") strip to top and bottom.

FINISHING: Cut batting and backing 3" larger than top on all sides. Layer backing, batting and top together and baste or pin. Quilt as desired. When quilting is completed, trim excess batting and backing. Bind as usual.

WOF=WIDTH OF FABRIC LOF = LENGTH OF FABRIC
@=DIRECTIONAL FABRIC * SEW STRIPS VIA SHORT ENDS THEN GO TO ASSEMBLY

BLOCK ASSEMBLY: Refer to BLOCK DIAGRAMS .

1. Draw a diagonal line on wrong side of (1) **G** 2-3/4" square. Place **G** square in one corner of (1) **E** 2-3/4" X 5" rectangle and sew on diagonal line. Press **G** open towards **E** corner. Trim excess fabric on reverse side to 1/4". Repeat on other side. Square to 2-3/4" X 5". Make (20) **GEG UNITS**.

2. Sew (1) **E** 2-3/4" square to each side of (1) **GEG UNIT** to create **EGEGE UNIT**, Make (10).

3. Sew (1) **GEG UNIT** to the each side of (1) **D** 5" square, then sew (1) **EGEGE UNIT** to top and bottom to complete **BLOCK 1**. Square to 9-1/2", Make (5).